

KANSAI UNIVERSITY

Intensive Japanese Language and Culture Course (IJLC) Summer 2018

Notice

Intensive Japanese Language and Culture Course (IJLC) Winter 2019

IJLC Winter 2019 will start from Mid-January and Early February, 2019

Details will be available on our website in July, 2018

http://www.kansai-u.ac.jp/Kokusai/english/from/program.php?id=culture_03

INDEX

Kansai University	1
Japanese Language and Culture Program Preparatory Course (<i>Bekka</i>) ...	1
Intensive Japanese Language and Culture Course (IJLC)	1
Dates.....	1
Eligible Participants	1
Course Contents	2
Number of Participants per Class	2
Campus	2
Class Levels	2
Fees.....	3
Visa.....	4
Application Period	4
Application Procedure	4
Application Documents.....	4
Schedule for Further Procedure	5
Payment of Fee	5
Course Schedule	6
Kansai University International Dormitory	7
Kansai University Minami-Senri International Plaza Dormitory	8
Dormitory Tsukigaoka	9
Crystal Hotel Minami-Senri.....	10

Kansai University Japanese Language and Culture Program will follow the Japanese laws, guidelines, and other norms concerning the use of personal information(address, name, telephone number or personally identifiable information) provided by the applicant.

When applying for the Course, be sure to refer to the following website for more details about the use of personal information: <http://www.kansai-u.ac.jp/ku-jpn/privacy/index.html>

2018 Summer
Intensive Japanese Language and Culture Course (IJLC)
Course Guide

Kansai University (KU), known as one of the leading universities in Japan with old history of over 130 years, is a comprehensive private university with 13 undergraduate, 13 graduate programs, and 3 professional graduate schools. There are over 30,000 students enrolled at the university including more than 900 international students. KU campuses are located in Osaka. They are about an hour train ride away from Kyoto, Kobe and Nara.

Under the new vision for internationalization entitled “Kansai University Global Initiatives” (GI Vision), KU opened the *Bekka* “Japanese Language and Culture Program Preparatory Course” in 2012. This unique course is designed to enhance Japanese language proficiency, media literacy and inter-cultural competency. Currently, over 100 international students from various countries and regions with large portion of students from Asia are enrolled in the course. They are striving to move on to the next stage of education at Japanese universities at both undergraduate and graduate levels.

We are now offering an Intensive Japanese Language and Culture Course (IJLC) in addition to the Preparatory Course (*Bekka*). IJLC will have sessions in summer and winter. In this IJLC, we provide instruction in Japanese as a second language as well as Japanese culture experiences and field trips (e.g. to Kyoto). Participants will learn Japanese language, and understand Japanese culture and society from various perspectives. Another feature of the IJLC is that the participants will have opportunities to interact with KU Japanese students through a variety of activities. In summary, participants will have opportunities to learn communicative Japanese and truly experience the vibrant cities and people of Western Japan.

Dates

Summer 1: Tuesday, June 5 2018 - Tuesday, June 26, 2018 (22 days)

Summer 2: Tuesday, July 3, 2018 - Wednesday, July 25, 2018 (23 days)

*Application can be made for above either 1 or 2.

Eligible Participants

Undergraduate or graduate level students

Course Contents

Japanese language classes
Japanese culture experience (e.g., tea ceremony)
Field trips (e.g. to Kyoto)
Interaction with KU students

Number of Participants per Class

Approximately 10-20 students per class
(Class will be cancelled if there are fewer than 10 participants.)

Campus

Kansai University Minami-senri International Plaza

Class Levels: 3 levels

Participants will be placed in an appropriate level of study based on an on-line placement test completed before coming to Japan.

Beginner Class

This is an introductory class for students with a very basic knowledge of Japanese who can read *Hiragana* and *Katakana* and understand basic Japanese such as greetings. This class is equivalent to JLPT N5 level or lower.

Beginner-Intermediate (Lower) Class

This class is for students who can understand and use basic Japanese. This class is equivalent to JLPT N4 - N3 level.

Intermediate (Upper)-Advanced Class

This class is for students who have studied and acquired beginner level of Japanese and have started studying intermediate Japanese. The students should be able to communicate with others using basic Japanese. This class is equivalent to JLPT N2 and higher.

*JLPT: Japanese Language Proficiency Test

*Class will be finalized by the interview after your arrival.

*Before starting IJLC, reading and writing of Hiragana and Katakana and basic Japanese such as greetings needs to be acquired.

*PC or tablet computer and USB memory are needed.

Fees (per person)

(Unit: Japanese yen)

Accommodation Option	Fees	
	Summer 1	Summer 2
Course fee + Kansai University International Dormitory Single room (shared shower and toilet)	194,600	195,600
Course fee + Kansai University Minami-Senri International Plaza Dormitory Single room (equipped with own bath with toilet)	208,600	210,200
Course fee + Dormitory Tsukigaoka Twin rooms at dormitory for female, sharing a room with another student on the course, shared shower and toilet	194,600	195,600
Course fee + Homestay (Inc. breakfast and dinner) You'll be picked up by your host family after arriving at Minami-Senri International Plaza. The transportation fee for commuting between campus and host family's home is not included in the course fee.	249,600	252,600
Course fee + Crystal Hotel Minami-Senri Single room (with bath and toilet)	285,600	291,600

*If you arrange accommodations by yourself, please ask us (ijlc@ml.kandai.jp) about fees.

*Overseas travel accident insurance: JPY 15,950

*Short-Term Homestay Fees (Optional) Twin room: JPY 16,000 for 2nights

*The above fee includes:

Japanese language class

Accommodation fee

Transportation fees between the Kansai International Airport (KIX) and each
accommodation on arrival and departure

Japanese culture experience (e.g. tea ceremony)

Field trip (e.g. to Kyoto)

Interactions with KU students

Course materials

*The above fee does NOT include:

Airfares

Overseas travel accident insurance

Meals and any other living expenses

Note: Overseas travel accident insurance specified by Kansai University is mandatory for all participants. Its cost will be added to the bill on top of the above fees.

VISA

In case a Visa is required by Ministry of Foreign Affairs to participate in this program, applicants are responsible for obtaining the appropriate Visa. Consult the website of Ministry of Foreign Affairs or the nearest Embassy or the Consulate General of Japan for more information and advice before applying for the course.

http://www.mofa.go.jp/j_info/visit/visa/index.html

Application Period

Summer 1: Friday, December 1, 2017 – Thursday, March 15, 2018

Summer 2: Friday, December 1, 2017 – Friday, April 13, 2018

Application Procedure

Email application documents to ijlc@ml.kandai.jp by the end of the application period.

Application Documents

- Two application forms (Forms can be downloaded from the URL as follows)
http://www.kansai-u.ac.jp/Kokusai/doc/application_form_IJLC.xls
(Fill in above excel files and send the files by E-mail.)
- Scanned datum of student's ID or Certificate of Enrollment from university (Certification Document issued by the university or other educational institution where the applicant is enrolled or affiliated.)

The Office of the IJLC will inform applicants of placement test within a week from the receipt of application. If applicants don't receive any reply in a week, please inquire ijlc@ml.kandai.jp

Schedule for Further Procedure

Summer 1	Summer 2	
Early April	Early May	Class cancellation decided, announcement for payment and further procedure
Mid April	Mid May	Payment deadline, Letter of Acceptance to be sent to applicants after confirmation of the payment
Mid May	Mid June	Announcement for pickup time at an airport

Payment of Fee

Accepted applicants will receive an E-mail with guidelines for payment of fees after the application is closed. Follow the guidelines and pay the required fees by the deadline.

A money transfer from outside of Japan may take time. Be sure to make the payment well in advance so that it will be completed by the deadline.

As a rule, the course fees once paid will not be refunded.

Course Schedule

*The schedule is subject to change.

Summer 1

Day	Date / Period	1st period	2nd period	3rd period	4th period	Lunch Break	5th period	6th period	7th period	8th period	Memo
	Class Hours	9:00 - 9:50	10:00 - 10:50	11:00 - 11:50	12:00 - 12:50	12:50 - 13:30	13:30 - 14:20	14:30 - 15:20	15:30 - 16:20	16:30 - 17:20	
Day 1	Jun 5 Tue	Arrival -Check in									
Day 2	Jun 6 Wed	Orientation IT Room			Preparatory Study about Sado Plaza Hall	Welcome Party Multipurpose Room		Sentryama Campus Tour Meeting Place: Multipurpose Room			
Day 3	Jun 7 Thu	Japanese	Japanese	Japanese	Japanese	CONSULTATION class level (only who wish to change levels)					
Day 4	Jun 8 Fri	Japanese	Japanese	Japanese	Japanese	FX class level					
Day 5	Jun 9 Sat	Free									
Day 6	Jun 10 Sun	Field Trip 1									
Day 7	Jun 11 Mon	Japanese	Japanese	Japanese	Japanese						
Day 8	Jun 12 Tue	Japanese	Japanese	Japanese	Japanese		Japanese Culture Experience (Tea Ceremony) Multipurpose Room				
Day 9	Jun 13 Wed	Japanese	Japanese	Japanese	Japanese						
Day 10	Jun 14 Thu	Japanese	Japanese	Japanese	Japanese	Interaction with KU students Multipurpose Room					
Day 11	Jun 15 Fri	Japanese	Japanese	Japanese	Japanese		Japanese Culture Experience (Yukata & Bon- odori) Multipurpose Rm				
Day 12	Jun 16 Sat	Free									
Day 13	Jun 17 Sun	Field Trip ②									
Day 14	Jun 18 Mon	Japanese	Japanese	Japanese	Japanese						
Day 15	Jun 19 Tue	Japanese	Japanese	Japanese	Japanese						
Day 16	Jun 20 Wed	Japanese	Japanese	Japanese	Japanese						
Day 17	Jun 21 Thu	Japanese	Japanese	Japanese	Japanese						
Day 18	Jun 22 Fri	Japanese	Japanese	Japanese	Japanese		Japanese	Japanese			
Day 19	Jun 23 Sat	Free									Short-term homestay
Day 20	Jun 24 Sun	Free									
Day 21	Jun 25 Mon	Final Presentation * 10:30- Questionnaire		Closing Ceremony Plaza Hall	Farewell Party Multipurpose Room						
Day 22	Jun 26 Tue	Check Out -Departure									

Summer 2

Day	Date / Period	1st period	2nd period	3rd period	4th period	Lunch Break	5th period	6th period	7th period	8th period	Memo	
Class Hours		9:00 - 9:50	10:00 - 10:50	11:00 - 11:50	12:00 - 12:50	12:50 - 13:30	13:30 - 14:20	14:30 - 15:20	15:30 - 16:20	16:30 - 17:20		
Day 1	Jul 3 Tue	Arrival - Check in										
Day 2	Jul 4 Wed	Orientation Plaza Hall			Preparatory Study about Sado Plaza Hall	Welcome Party Multipurpose Room		Sentryama Campus Tour Meeting Place: Multipurpose Room				
Day 3	Jul 5 Thu	Japanese	Japanese	Japanese	Japanese	CONSULTATION class level (only who wish to change levels)						
Day 4	Jul 6 Fri	Japanese	Japanese	Japanese	Japanese	FDK class level	Japanese Culture Experience (Tea Ceremony) Multipurpose Rm					
Day 5	Jul 7 Sat	Free										
Day 6	Jul 8 Sun	Field Trip 1										
Day 7	Jul 9 Mon	Japanese	Japanese	Japanese	Japanese							
Day 8	Jul 10 Tue	Japanese	Japanese	Japanese	Japanese							
Day 9	Jul 11 Wed	Japanese	Japanese	Japanese	Japanese							
Day 10	Jul 12 Thu	Japanese	Japanese	Japanese	Japanese		Japanese Culture Experience (Yukata & Bon odori) Multipurpose Rm					
Day 11	Jul 13 Fri	Japanese	Japanese	Japanese	Japanese	Interaction with KU students Meeting Place: Multipurpose Room						
Day 12	Jul 14 Sat	Free										Short-term homestay (For applicants only)
Day 13	Jul 15 Sun	Free										
Day 14	Jul 16 Mon	Free										
Day 15	Jul 17 Tue	Japanese	Japanese	Japanese	Japanese							
Day 16	Jul 18 Wed	Japanese	Japanese	Japanese	Japanese							
Day 17	Jul 19 Thu	Japanese	Japanese	Japanese	Japanese							
Day 18	Jul 20 Fri	Japanese	Japanese	Japanese	Japanese							
Day 19	Jul 21 Sat	Free										
Day 20	Jul 22 Sun	Field Trip 2										
Day 21	Jul 23 Mon	Japanese	Japanese	Japanese	Japanese		Japanese	Japanese				
Day 22	Jul 24 Tue	Final Presentation * 10:30- Questionnaire		Closing Ceremony Plaza Hall	Farewell Party Multipurpose Room							
Day 23	Jul 25 Wed	Check Out - Departure										

Accommodation Details

○ Kansai University International Dormitory



This is a dormitory for international students located 10 minutes away on foot from Minami-Senri station, and 20 minutes away by bicycle from Kansai University Senriyama campus. Kansai University students, mostly exchange students and full-time-international students are main residents in this dormitory. Resident assistants (RA) will support the daily life of the international

students. All rooms are single occupancy and there are shared kitchen, shower room, washroom, and toilet on each floor. All rooms are equipped with air conditioner/heater.

There are multipurpose room and study room available for the students encouraging active interactions among students. The dormitory is mixed with each floor segregated by gender.

1. Dormitory specifications

Address	3-3 Tsukumodai, Suita-Shi, Osaka 565-0862
Building	5 story building (a residential facility for both males and females)
Establishment	1964 (Renovation work completed in 2008)
Number of rooms	140 rooms
Residence room size	Approximately 8.0 m ²
Security system	Self-locking doors. Manager is available 24 hours a day, 7 days a week.
Meals	No meal plan at this dormitory (Prepare on your own.)
Room furnishings	bed, desk, chair, book shelf, closet, wired and wireless internet LAN, refrigerator, air conditioner, window curtain, linen, desk light, dustbin, drying pole
Unit Amenities	kitchen (cookware, oven toaster, microwave), toilet, washroom, shower room, laundry room (washer & drier), elevator, rental articles (vacuum cleaner, iron, ironing board)
Common area facilities	multipurpose room, study room, bicycle stand
Resident Assistant	3 resident assistants on each floor. (Maximum 15 RAs)

2. Room Layout

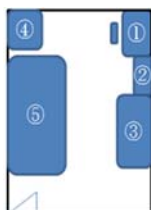

- ① desk
- ② bookshelf
- ③ closet
- ④ refrigerator
- ⑤ bed

3. Dormitory Photos

https://www.kansai-u.ac.jp/Kokusai/english/pdf/dormitory_photo.pdf

○ Kansai University Minami-Senri International Plaza Dormitory



This is a dormitory for international students located 5 minutes away on foot from Minami-Senri station, and 15 minutes away by bicycle from Kansai University Senriyama campus. *Bekka* students at Kansai University and exchange students are the main residents in this dormitory and Resident assistants (RA) will support the daily life of the international students. All rooms are single

occupancy and each unit is composed of 6 - 7 rooms, sharing a kitchen, lounge and laundry room, so that students can spend time together. There will be culture exchange events with people from the local community.

1. Dormitory specifications

Address	1-2-20, Satakedai, Suita-shi, Osaka 565-0855
Building	8 story building (a residential facility for both males and females)
Establishment	2012
Number of rooms	165rooms
Residence room size	14 m ²
Security system	Self-locking doors. Manager is available 24 hours a day, 7 days a week.
Meals	No meal plan at this dormitory (Prepare on your own.)
Room furnishings	bed, desk, chair, storage, book shelf, shoe rack, bath with toilet, wired internet LAN ,refrigerator, air conditioner, window curtain, linen, desktop light, dustbin, drying pole
Unit amenities	kitchen(kitchen cookware, oven toaster, microwave, cabinet for tableware), lounge(dining table & chairs, wireless LAN), air conditioner, laundry room(washer & drier) , vacuum cleaner, iron & ironing board, TV, garbage bin
Common area facilities	multi-purpose room (wireless LAN, kitchen), recreation room, Japanese room, bicycle stand
Resident Assistant	RA in each unit (maximum 24 RAs) ※4 units on each floor.

2. Room Layout

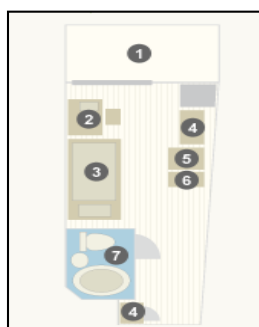

- ① balcony
- ② desk
- ③ bed
- ④ bookshelf
- ⑤ storage space
- ⑥ refrigerator
- ⑦ bath with toilet

3. Dormitory Photos

<http://www.kansai-u.ac.jp/ku-jpn/English/campuslife/introduction/index.html>

○ Dormitory Tsukigaoka



Dormitory Tsukigaoka is a female-only dormitory situated on a hill in a quiet environment. It comes with a great view and is located 15 minutes away on foot from Minami-Senri International Plaza where the IJLC is held. All of the rooms are twin rooms and there are shared facilities such as bathrooms and dining hall. Dormitory

manager is on duty 24 hours a day, 7 days a week and the front door locks automatically for security.

1. Dormitory specifications

Address	25 Senriyama Tsukigaoka, Suita-shi, Osaka 565-0847
Building	4 story building with a lower ground floor (a residential facility for females only)
Capacity	102 person
Residence room size	14 m ²
Security system	Self-locking doors. Manager on duty 24 hours a day, 7 days a week.
Meals	No meal plan at this dormitory (Prepare on your own.)
Room furnishings	Twin room with bed, desk, chair, closet, curtain
Common area facilities	Kitchen, dining room, main bath, shower room, Japanese room, library, lounge, laundry room(washer & drier)

2. Room Layout

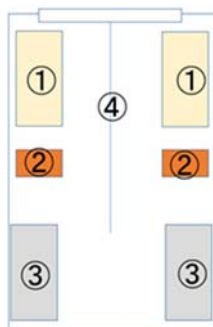

- ① bed
- ② desk
- ③ closet
- ④ curtain

3. Dormitory Photos

<http://www.kansai-u.ac.jp/gakusei/lifestyle/dormitory/moonhill.html>

- Crystal Hotel Minami-Senri

<http://www.crystalhotel.jp/facilities.html>

Center for International Education, Kansai University
1-2-20, Satakedai, Suita-shi, Osaka, 565-0855 Japan
TEL : +81-(0)6-6831-9180 FAX: +81-(0)6-6831-9194

Website:

http://www.kansai-u.ac.jp/Kokusai/english/from/program.php?id=culture_03

Email: ijlc@ml.kandai.jp